

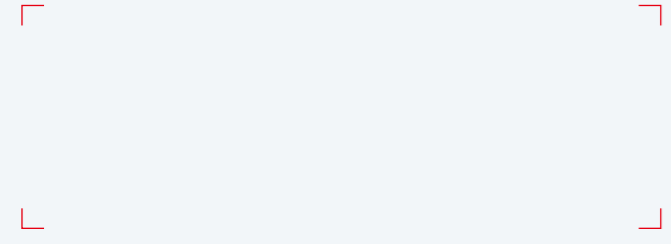

PRODUCT QUICK GUIDE  
**INTELLIGENT SECURITY INSPECTION**

Distributed by



Follow us on social media to get the latest product and solution information



[www.hikvision.com](http://www.hikvision.com)  
[support@hikvision.com](mailto:support@hikvision.com)



PRODUCT QUICK GUIDE  
**INTELLIGENT SECURITY INSPECTION**





# Intelligent Security Inspection

## Uncover concealed threats in smarter ways

### Intelligent recognition technology

> Hikvision's security inspection system leverages cutting-edge intelligent recognition and high-quality X-ray imaging to enhance safety. It accurately identifies 35 categories and 64 types of common contraband, providing real-time detection results with alarms, which can be transmitted to the management platform for comprehensive data analysis and event tracing.

### Multi-dimensional data perception

> Powered by AI, IoT and big data technologies, the system seamlessly integrates diverse inspection data, including X-ray images, videos, metal detection results, and more. It offers automatic video correlation, real-time previews, and retrospective playback, all accessible from a centralized management platform.

### Centralized management & Easy integration

> Easily incorporate local data into existing management systems, including third-party platforms. Hikvision offers a solution that allows management staff to monitor real-time operations, access maintenance information, and more, significantly improving operational efficiency.

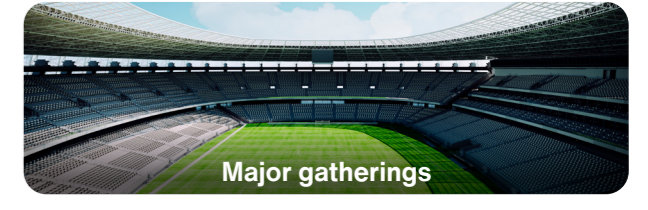
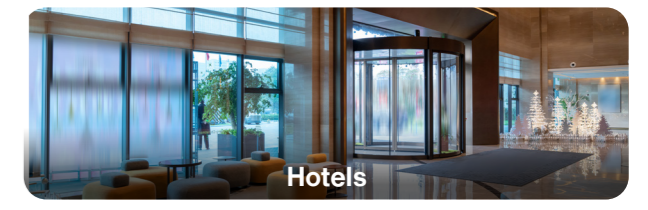
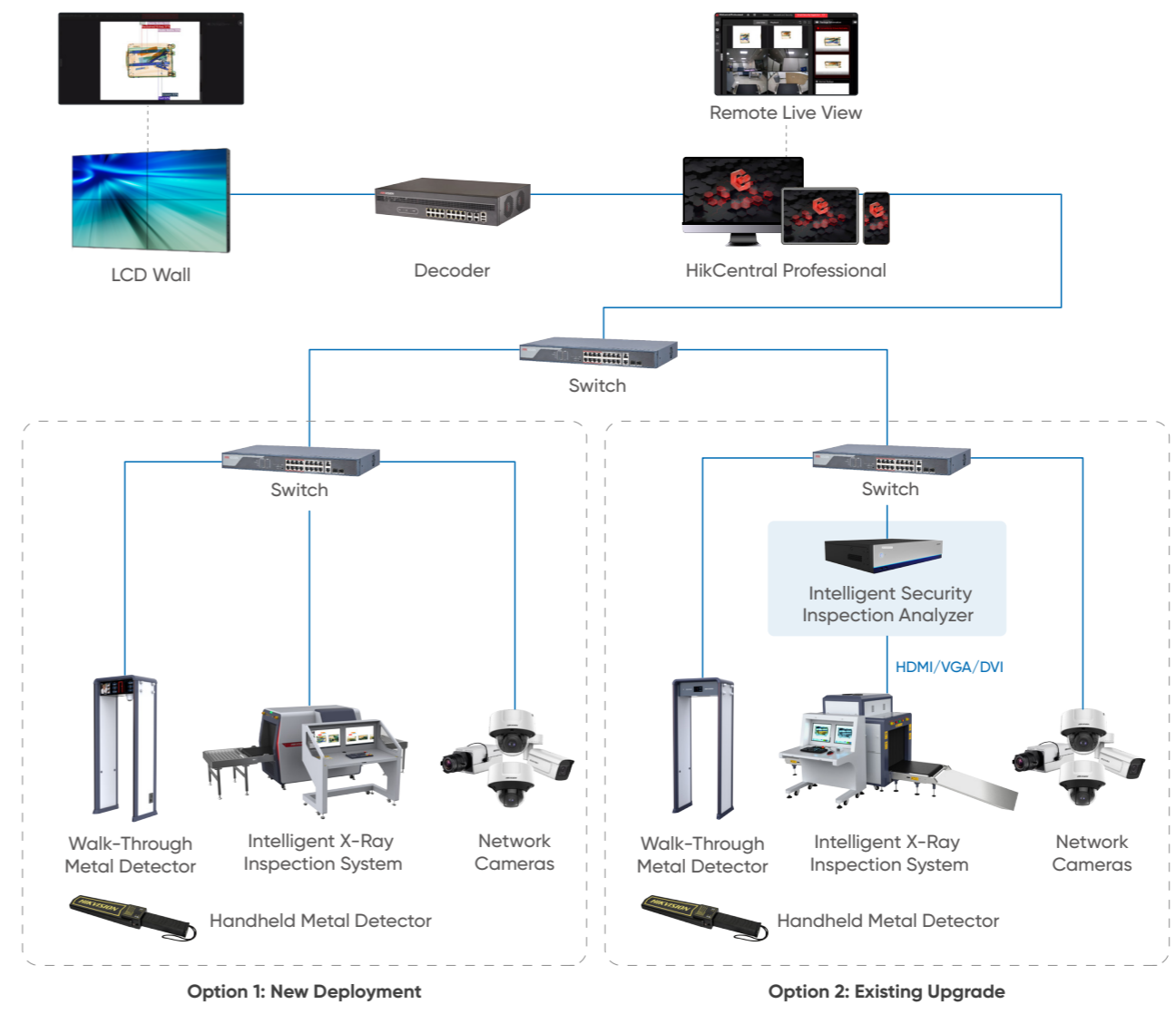
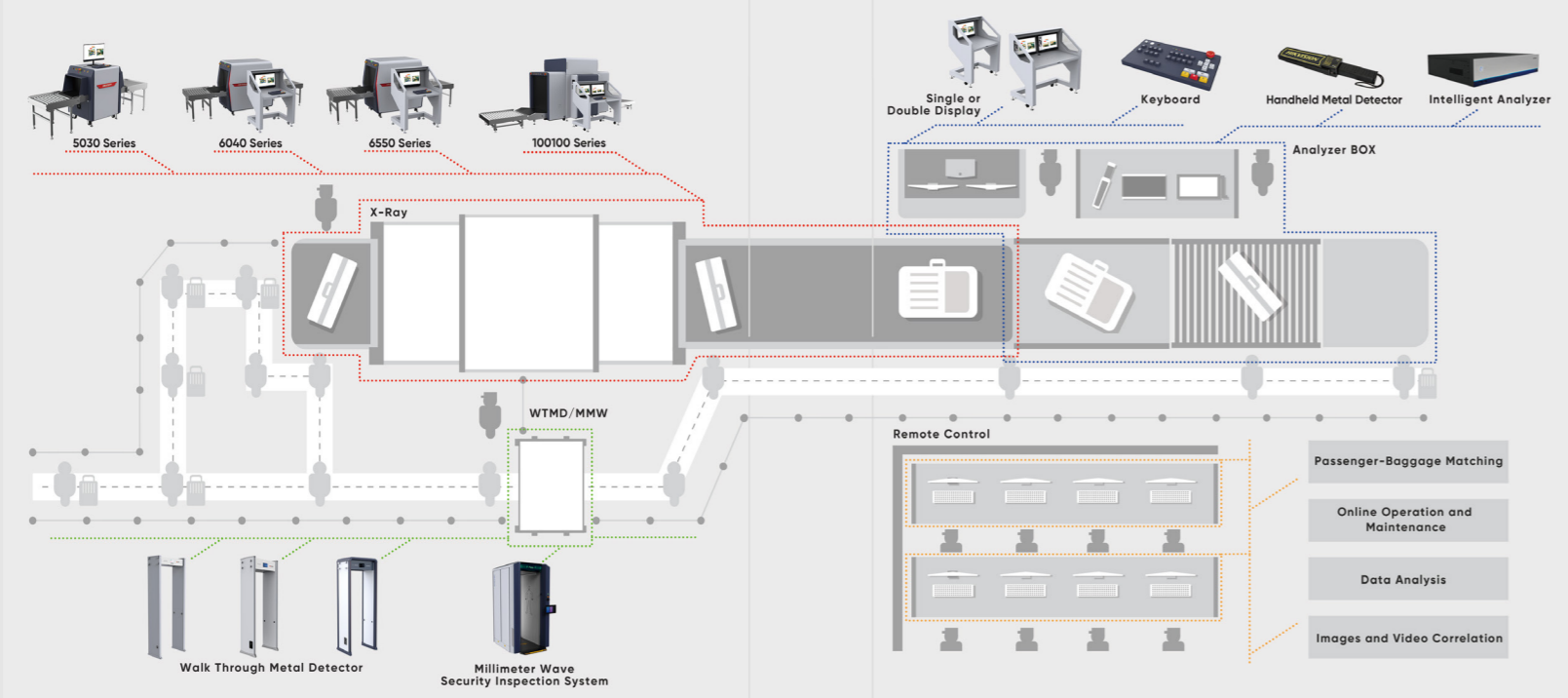



# X-ray Inspection System

## Advanced recognition technology

With proprietary intellectual property rights, the deep-learning recognition algorithm seamlessly integrates with X-ray imaging software to deliver superior detection capabilities.

## HD images with Raytina 2.0 Algorithm Engine

By using a high-performance image processor and the new-gen image algorithm engine, the system delivers true image restoration, producing clearer and more detailed images.

## Convenient networking and data storage

Hikvision's security inspection system integrates with leading management platforms for efficient data management. Locally stored data, such as images and alarm details, can be accessed and reviewed simultaneously.

## Adjustable speed

Easily adjust the speed of the X-ray device with a single switch to suit different operational scenarios.

## Traceback and correlation

Effortlessly link X-ray images of baggage with corresponding video footage to replay and analyze past events.

## High-level radiation safety

Hikvision's safety protocols ensure radiation levels are close to natural environmental levels, significantly lower than international standards.

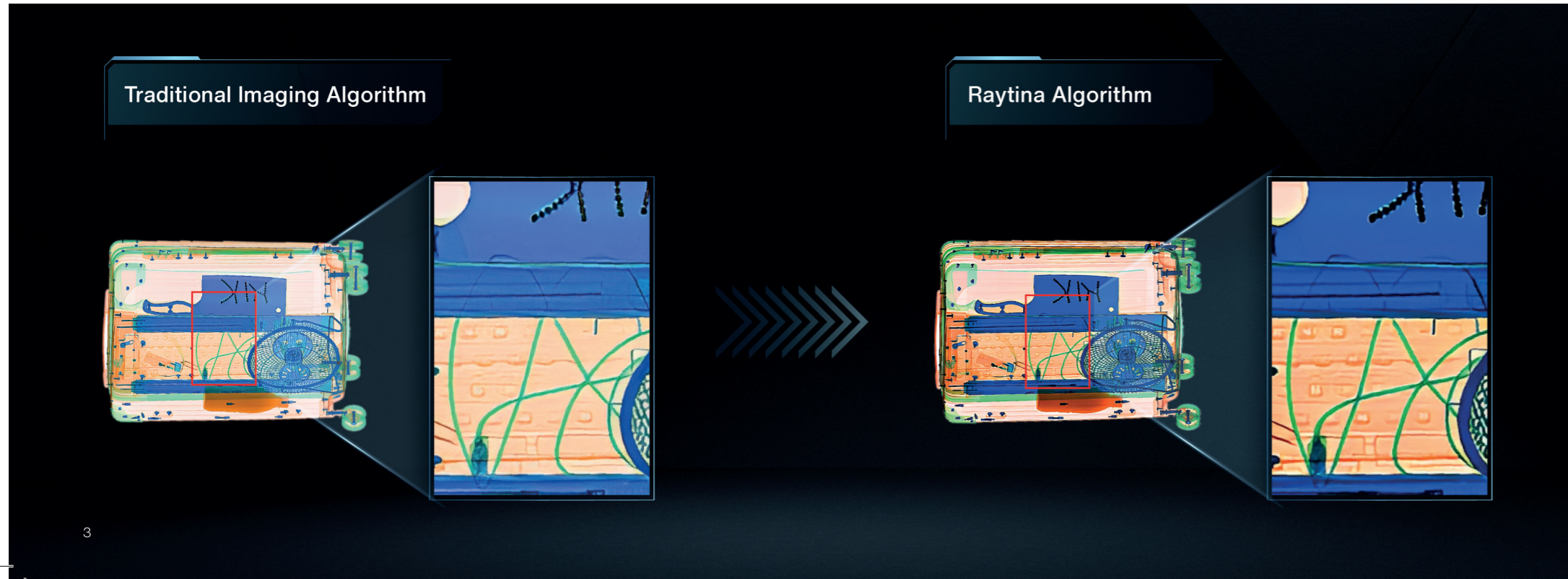

## X-ray Inspection System

Model	ISD-SC5030S-H2CVL	ISD-SC6040S-H4CVL	ISD-SC6040D-H4CVL	ISD-SC6550S-H4CVL	ISD-SC6550D-H4CVL	ISD-SC100100S-H4CVL	ISD-SC100100D-H4CVL	
<b>Image</b>								
<b>Tunnel Size</b>	500 × 300 mm (W × H)	620 × 420 mm (W × H)	620 × 420 mm (W × H)	650 × 500 mm (W × H)	650 × 500 mm (W × H)	1000 × 1000 mm (W × H)	1000 × 1000 mm (W × H)	
<b>Dimension</b>	1483 × 730 × 1060 mm (L × W × H)	2011 × 957 × 1260 mm (L × W × H)	2311 × 1283 × 1285 mm (L × W × H)	2011 × 957 × 1260 mm (L × W × H)	2311 × 1283 × 1285 mm (L × W × H)	3279 × 1296 × 1810 mm (L × W × H)	3576 × 1536 × 1828 mm (L × W × H)	
<b>Operation Desk Size</b>	/	850 × 650 × 1180 mm (L × W × H)	1200 × 650 × 1180 mm (L × W × H)	850 × 650 × 1180 mm (L × W × H)	1200 × 650 × 1180 mm (L × W × H)	850 × 650 × 1180 mm (L × W × H)	1200 × 650 × 1180 mm (L × W × H)	
<b>Wire Resolution</b>	38 AWG standard, 40 AWG typical	38 AWG standard, 40 AWG typical	38 AWG standard, 40 AWG typical	38 AWG standard, 40 AWG typical	38 AWG standard, 40 AWG typical	36 AWG standard, 38 AWG typical	36 AWG standard, 38 AWG typical	
<b>Steel Penetration</b>	30 mm standard, 32 mm typical	32 mm standard, 36 mm typical	32 mm standard, 36 mm typical	32 mm standard, 36 mm typical	32 mm standard, 36 mm typical	30 mm standard, 34 mm typical	30 mm standard, 34 mm typical	
<b>X-Ray Generator</b>	140 kV / 0.8 mA (Adjustable)	160 kV / 1.0 mA (Adjustable)	160 kV / 1.0 mA (Adjustable)	160 kV / 1.0 mA (Adjustable)	160 kV / 1.0 mA (Adjustable)	160 kV / 1.0 mA (Adjustable)	160 kV / 1.0 mA (Adjustable)	
<b>Generator Cooling</b>	Oil-cooling / Continuous	Oil-cooling / Continuous	Oil-cooling / Continuous	Oil-cooling / Continuous	Oil-cooling / Continuous	Oil-cooling / Continuous	Oil-cooling / Continuous	
<b>Orientation</b>	Vertically upward	Vertically upward	Horizontal and vertically upward	Vertically upward	Horizontal and vertically upward	Vertically downward	Vertically downward & Horizontal	
<b>External Dose Rate</b>	<1.0 μSv/h (100 mm away from the device surface)	<1.0 μSv/h (100 mm away from the device surface)	<1.0 μSv/h (100 mm away from the device surface)	<1.0 μSv/h (100 mm away from the device surface)	<1.0 μSv/h (100 mm away from the device surface)	<1.0 μSv/h (100 mm away from the device surface)	<1.0 μSv/h (100 mm away from the device surface)	
<b>Film Safety</b>	Standard of ASA / ISO1600	Standard of ASA / ISO1600	Standard of ASA / ISO1600	Standard of ASA / ISO1600	Standard of ASA / ISO1600	Standard of ASA / ISO1600	Standard of ASA / ISO1600	
<b>Conveyor Height</b>	600 mm	600 mm	600 mm	600 mm	600 mm	300 mm	300 mm	
<b>Conveyor Speed</b>	0.2 m/s, 0.3 m/s adjustable	0.2 m/s, 0.3 m/s, 0.4 m/s adjustable	0.2 m/s, 0.3 m/s, 0.4 m/s adjustable	0.2 m/s, 0.3 m/s, 0.4 m/s adjustable	0.2 m/s, 0.3 m/s, 0.4 m/s adjustable	0.2 m/s, 0.3 m/s, 0.4 m/s adjustable	0.2 m/s, 0.3 m/s, 0.4 m/s adjustable	
<b>Conveyor Capacity</b>	100 kg	165 kg	165 kg	165 kg	165 kg	200 kg	200 kg	
<b>Sensor Type</b>	1/2.8" Progressive Scan CMOS	1/2.8" Progressive Scan CMOS	1/2.8" Progressive Scan CMOS	1/2.8" Progressive Scan CMOS	1/2.8" Progressive Scan CMOS	1/2.8" Progressive Scan CMOS	1/2.8" Progressive Scan CMOS	
<b>Cameras</b>	3-ch	6-ch	6-ch	6-ch	6-ch	6-ch	6-ch	
<b>Video Compression Standard</b>	H.265 / H.264 / MJPEG	H.265 / H.264 / MJPEG	H.265 / H.264 / MJPEG	H.265 / H.264 / MJPEG	H.265 / H.264 / MJPEG	H.265 / H.264 / MJPEG	H.265 / H.264 / MJPEG	
<b>Max. Image Size</b>	1920 × 1080	1920 × 1080	1920 × 1080	1920 × 1080	1920 × 1080	1920 × 1080	1920 × 1080	
<b>Vide Storage</b>	More than 30 days	More than 30 days	More than 30 days	More than 30 days	More than 30 days	More than 30 days	More than 30 days	
<b>Screen Size</b>	23.8", Single-screen	23.8", Single-screen	23.8", Single-screen	23.8", Single-screen	23.8", Single-screen	23.8", Single-screen	23.8", Single-screen	
<b>Display Resolution</b>	1920 × 1080@120 Hz	1920 × 1080@120 Hz	1920 × 1080@120 Hz	1920 × 1080@120 Hz	1920 × 1080@120 Hz	1920 × 1080@120 Hz	1920 × 1080@120 Hz	
<b>AI Identification Items</b>	35 Categories with 64 types	35 Categories with 64 types	35 Categories with 64 types	35 Categories with 64 types	35 Categories with 64 types	35 Categories with 64 types	35 Categories with 64 types	
<b>Login Method</b>	Fingerprint / Password	Face / Fingerprint / Password	Face / Fingerprint / Password	Face / Fingerprint / Password	Face / Fingerprint / Password	Face / Fingerprint / Password	Face / Fingerprint / Password	
<b>Image Recall</b>	Recall infinitely	Recall infinitely	Recall infinitely	Recall infinitely	Recall infinitely	Recall infinitely	Recall infinitely	
<b>Image Storage Capability</b>	100,000+	100,000+	100,000+	100,000+	100,000+	100,000+	100,000+	
<b>Power Consumption</b>	Max. 0.6 kW	Max. 0.8 kW	Max. 1.0 kW	Max. 0.8 kW	Max. 1.0 kW	Max. 0.8 kW	Max. 1.2 kW	
<b>Power Supply</b>	AC 110V to 230V (-15% to +10%), 50Hz/60Hz (±3Hz)	AC 220 V (-15% to +10%), 50 Hz / 60 Hz (±3 Hz) AC 110 V (-15% to +10%), 50 Hz / 60 Hz (±3Hz)	AC 220 V (-15% to +10%), 50 Hz / 60 Hz (±3 Hz) AC 110 V (-15% to +10%), 50 Hz / 60 Hz (±3Hz)	AC 220 V (-15% to +10%), 50 Hz / 60 Hz (±3 Hz) AC 110 V (-15% to +10%), 50 Hz / 60 Hz (±3Hz)	AC 220 V (-15% to +10%), 50 Hz / 60 Hz (±3 Hz) AC 110 V (-15% to +10%), 50 Hz / 60 Hz (±3Hz)	AC 220 V (-15% to +10%), 50 Hz / 60 Hz (±3 Hz) AC 110 V (-15% to +10%), 50 Hz / 60 Hz (±3Hz)	AC 220 V (-15% to +10%), 50 Hz / 60 Hz (±3 Hz) AC 110 V (-15% to +10%), 50 Hz / 60 Hz (±3Hz)	AC 220 V (-15% to +10%), 50 Hz / 60 Hz (±3 Hz) AC 110 V (-15% to +10%), 50 Hz / 60 Hz (±3Hz)
<b>Noise Level</b>	60 dB(A), 1000 mm away from the device surface	60 dB(A), 1000 mm away from the device surface	60 dB(A), 1000 mm away from the device surface	60 dB(A), 1000 mm away from the device surface	60 dB(A), 1000 mm away from the device surface	60 dB(A), 1000 mm away from the device surface	60 dB(A), 1000 mm away from the device surface	
<b>Operating Temperature / Humidity</b>	5 to 40°C / 10% to 95% (non-condensing)	5 to 40°C / 10% to 95% (non-condensing)	5 to 40°C / 10% to 95% (non-condensing)	5 to 40°C / 10% to 95% (non-condensing)	5 to 40°C / 10% to 95% (non-condensing)	5 to 40°C / 10% to 95% (non-condensing)	5 to 40°C / 10% to 95% (non-condensing)	
<b>Storage Temperature / Humidity</b>	-20 to 60°C / 0% to 95% (non-condensing)	-20 to 60°C / 0% to 95% (non-condensing)	-20 to 60°C / 0% to 95% (non-condensing)	-20 to 60°C / 0% to 95% (non-condensing)	-20 to 60°C / 0% to 95% (non-condensing)	-20 to 60°C / 0% to 95% (non-condensing)	-20 to 60°C / 0% to 95% (non-condensing)	
<b>Weight</b>	Net: approx. 460 kg	Net: approx. 710 kg	Net: approx. 800 kg	Net: approx. 710 kg	Net: approx. 800 kg	Net: approx. 1140 kg	Net: approx. 1170 kg	



## Walk-Through Metal Detector

### High detection accuracy

- Effectively detects metal objects as small as a coin, with reduced false alarms and no missed detections.

### People & Alarm counting

- Tracks the number of people and alarm events, displaying counts on the screen.

### Multi-zone detection

- Simultaneously detects metals in different zones.

### Adjustable sensitivity

- Tailor the sensitivity of each zone individually to suit different security needs.

### Networking capabilities

- Integrates with HikCentral Professional Platform for traffic flow analysis (excluding 1 series).

### Remote control

- Easily operated remotely using an remote controller unit or web browser, enhancing user convenience (excluding 1 series).

### Alarm outputs

- Equipped with two relay alarm outputs for flexible alert options (excluding 1 Series).



## Walk Through Metal Detector

Model	ISD-SM6533LC-1	ISD-SM6533L	ISD-SM6318L	ISD-SM6312L	ISD-SM6118	ISD-SM6112	ISD-SM6106C
Image							
Tunnel Size	2005 x 727 x 600 mm (H x W x D)	2005 x 727 x 600 mm (H x W x D)	1980 x 730 x 501 mm (H x W x D)	1980 x 730 x 501 mm (H x W x D)	2204 x 734 x 405 mm (H x W x D)	2204 x 734 x 405 mm (H x W x D)	2204 x 734 x 405 mm (H x W x D)
Dimension	2287 x 872 x 665 mm (H x W x D)	2287 x 872 x 665 mm (H x W x D)	2255 x 864 x 579 mm (H x W x D)	2255 x 864 x 579 mm (H x W x D)	2205 x 852 x 478 mm (H x W x D)	2205 x 852 x 478 mm (H x W x D)	2205 x 852 x 478 mm (H x W x D)
Detection Accuracy	One coin size (approx. φ25 mm) metal	One coin size (approx. φ25 mm) metal	One coin size (approx. φ25 mm) metal	One coin size (approx. φ25 mm) metal	One coin size (approx. φ25mm) metal	One coin size (approx. φ25 mm) metal	One coin size (approx. φ25 mm) metal
Detection Zones	33	33	18	12	18	12	6
Sensitivity Levels	0-999	0-999	0-999	0-999	255	255	255
Log in Method	Password	Password	Password	Password	Password	Password	Password
Control Method	Remote controller / website	Remote controller / website	Remote controller / website	Remote controller / website	Key	Key	Key
Display Type and Size	One 29-inch LCD color screen One 7-inch LCD color screen	One 7-inch LCD color screen	One 7-inch LCD color screen	One 7-inch LCD color screen	One 4.3-inch LCD color screen	One 4.3-inch LCD color screen	LED segment displays
Zones Alarm Indicator	Two side (entrance and exit) LED light bar	Two side (entrance and exit) LED light bar	Two side (entrance and exit) LED light bar	Two side (entrance and exit) LED light bar	Single side (entrance or exit) LED light bar	Single side (entrance or exit) LED light bar	6 red LED lamp
Flow Control for Specified Area Standard System Functions	<ul style="list-style-type: none"> <li>Time / Date</li> <li>Passage counting</li> <li>Power on self-diagnostics</li> <li>Sensitivity adjustment</li> <li>Frequency adjustment</li> <li>Environment calibration</li> <li>Multiple detection mode</li> <li>Match automatically frequency</li> <li>...</li> </ul>	<ul style="list-style-type: none"> <li>Time / Date</li> <li>Passage counting</li> <li>Power on self-diagnostics</li> <li>Sensitivity adjustment</li> <li>Frequency adjustment</li> <li>Environment calibration</li> <li>Multiple detection mode</li> <li>Match automatically frequency</li> <li>...</li> </ul>	<ul style="list-style-type: none"> <li>Time / Date</li> <li>Passage counting</li> <li>Power on self-diagnostics</li> <li>Sensitivity adjustment</li> <li>Frequency adjustment</li> <li>Environment calibration</li> <li>Multiple detection mode</li> <li>Match automatically frequency</li> <li>...</li> </ul>	<ul style="list-style-type: none"> <li>Time / Date</li> <li>Passage counting</li> <li>Power on self-diagnostics</li> <li>Sensitivity adjustment</li> <li>Frequency adjustment</li> <li>Environment calibration</li> <li>Multiple detection mode</li> <li>Match automatically frequency</li> <li>...</li> </ul>	<ul style="list-style-type: none"> <li>Time / Date</li> <li>Power on self-diagnostics</li> <li>Sensitivity adjustment</li> <li>Frequency adjustment</li> <li>...</li> </ul>	<ul style="list-style-type: none"> <li>Time / Date</li> <li>Power on self-diagnostics</li> <li>Sensitivity adjustment</li> <li>Frequency adjustment</li> <li>...</li> </ul>	<ul style="list-style-type: none"> <li>Sensitivity adjustment</li> <li>Frequency adjustment</li> <li>Multi-brightness of LED segment displays</li> <li>...</li> </ul>
Camera	1 pc	/	/	/	/	/	/
Power Interface	1 DC power interface	1 DC power interface	1 DC power interface	1 DC power interface	1 DC power interface	1 DC power interface	1 DC power interface
Network	1 RJ45 10/100 M Ethernet port	1 RJ45 10/100 M Ethernet port	1 RJ45 10/100 M Ethernet port	1 RJ45 10/100 M Ethernet port	/	/	/
Alarm Output	2 Relay outputs	2 Relay outputs	2 Relay outputs	2 Relay outputs	/	/	/
Power Supply	AC 100-240 V, 50/60 Hz	AC 100-240 V, 50/60 Hz	DC 12 V, 5 A	DC 12 V, 5 A	DC 15 V, 4 A	DC 15 V, 4 A	DC 15 V, 4 A
Power Consumption	Max. 40 W	Max. 25 W	Max. 60 W	Max. 60 W	Max. 10 W	Max. 10 W	Max. 10 W
Operation Temperature / Humidity	-20 to 55°C / 10% to 95% (non-condensing)	-10 to 55°C / 0% to 95% (non-condensing)	-20 to 45°C / 0% to 95% (non-condensing)	-20 to 45°C / 0% to 95% (non-condensing)	-20 to 45°C / 0% to 95% (non-condensing)	-20 to 45°C / 0% to 95% (non-condensing)	-20 to 45°C / 0% to 95% (non-condensing)
Safety Protection	IP41	IP41	IP41	IP41	IP41	IP41	IP41
Weight	Net: approx.89 kg	Net: approx.84 kg	Net: approx.62 kg	Net: approx.62 kg	Net: approx.35 kg	Net: approx.35 kg	Net: approx.35 kg



# Millimeter Wave Security Inspection System for Persons

## Comfortable and safe

> Individuals stand naturally with arms slightly open for a quick and simple stay. The system uses just 1% of a cell phone's transmit power, with millimeter waves reflecting off the skin without penetrating the body. This makes it safe for children, pregnant women, and the elderly, and it emits no ionizing radiation.

## Accurate and reliable

> Using E-band millimeter waves, the system offers a resolution of 2 mm, precisely showcasing the positions and shapes of hidden items. Deep learning algorithms identify both metal and non-metal objects, including firearms, explosives, knives, and hazardous materials.

## Fast and efficient

> Detection is completed within 4 seconds, allowing the system to manage over 700 people per hour efficiently through its intelligent platform, streamlining the manual inspection process.



### Millimeter Wave Security Inspection System

Model	ISD-SMW1701S-C
Image	
Dimensions	2436 x 1325 x 1500 mm (H x W x D)
Tunnel Size	2150 x 750 x 1275 mm (H x W x D)
Weight	600 kg
Power Supply	AC 220-230 V, 50/60 Hz
Power Consumption	900 W (Rated)
Operating Environment	Operating temperature: -5 to 45°C Relative humidity: 95% No condensation
Storage Environment	Storage temperature: -20 to 60°C Relative humidity: 95% No condensation
Inspection Method	Non-contact
Detection Time	≤4 s
Throughput	700 people/hour
Detectable Item Categories	Firearms, explosive or incendiary substances and devices, knives, dangerous goods, etc.
Detection Mode	Automatic mode Manual mode
Inspection Posture	Standing naturally with arms hanging down and slightly apart
Line Resolution	2 mm
Spatial Resolution	3 mm



## Auxiliary Equipment

### Intelligent Security Inspection Analyzer

> The Intelligent Security Inspection Analyzer supports seamless on-site transformation, allowing the security inspection machine to output signals directly. In the event of continuous power supply, the equipment can be ring-connected, ensuring uninterrupted on-site use.

### Handheld Metal Detector

> The Handheld Metal Detector is used for security checks at checkpoints and can also help prevent the theft of valuable metals.

### Desktop Liquid Detector

> The Desktop Liquid Detector can identify liquids in both metal and non-metal bottles or containers without the need to open them. It is specifically designed for liquid security inspection scenarios.

### Explosives Container

> The Explosives Container is designed to safely store explosives, significantly reducing the risks associated with potential explosions.

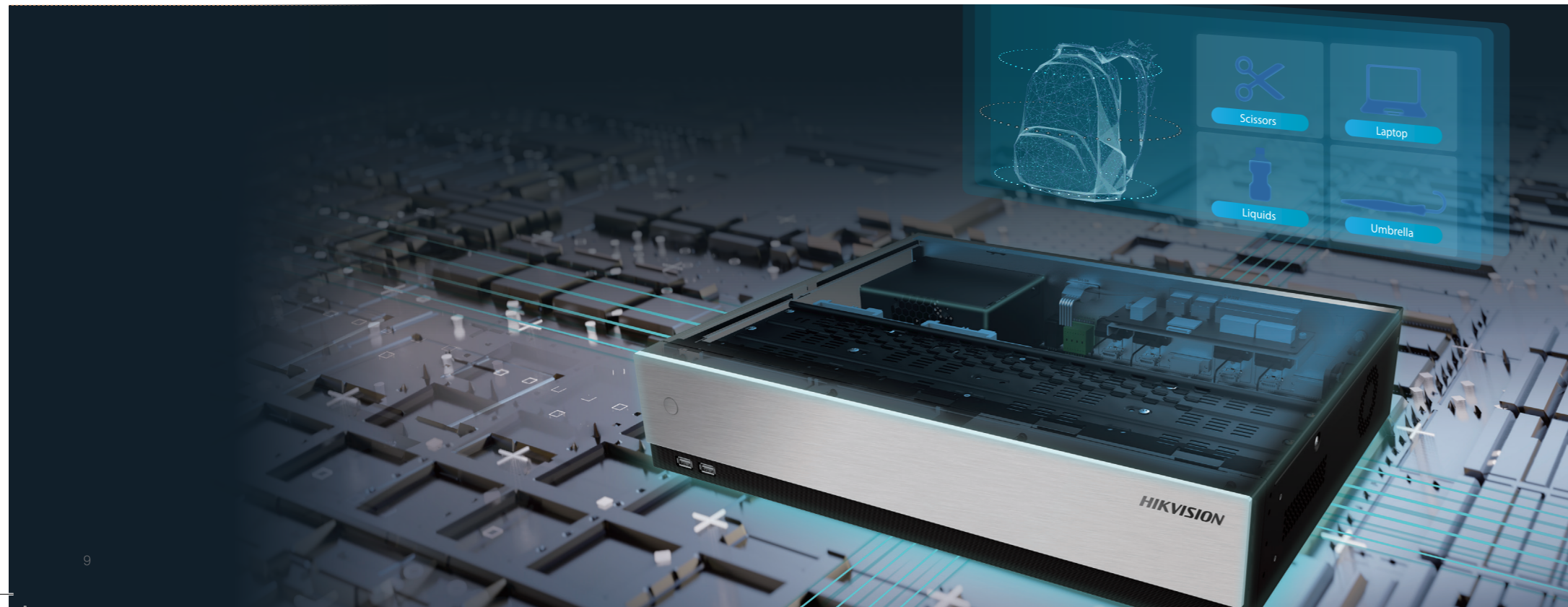

### Auxiliary Equipment

Model		ISD-ST204D-DHV
Image		
Dimension Parameters	Appearance and Dimension	440 x 90 x 340 mm (W x H x D)
	Operating Temperature	0 to 55°C
Specification Parameters	Weight	6.6 kg
	Operating Humidity	10% to 90% (No Condensation)
	Power	AC110-240 V (+10%-15%), 50±3 Hz
	Consumption	≤50 W
Device Interface	Network Interface	7
	USB Interface	2
	Video Input	VGA/HDMI: 2 Groups (HDMI has the priority)
	Video Output	VGA/HDMI: 2 Groups
	Alarm Input	2
	Alarm Output	3 Built-in 4 TB 3.5", SATA (12TB extendable)
	Serial Port	1, standard RS-232 full duplex serial port 1, standard RS-485 half-duplex serial port
Performance Parameters	Network Camera	4-ch IPC
Communication Protocol	Protocol	eHome, HIKSDK
Smart Analysis	Prohibited Goods Classification	50 Classes in 15 major types
	Prohibited Goods Type	Gun, cutter, spray irrigation, bottle of liquid, umbrella, battery, laptop, lighter, and fireworks
	Analysis Channel	1-ch front angle of view, 1-ch side of view

Model		ISD-SL300T
Image		
Technology		Ultra wideband pulse microwave reflection method; heat conduction technology
Detectable Container Material		Liquids packaged in different materials such as iron, aluminum, plastic, glass and ceramic
Detectable Liquid		Flammable, explosive and corrosive hazardous liquids
Detection Limits	Detection Volume	>42 ml
	Container Diameter Range	≥30 mm, ≤200 mm
	Liquid Level Requirements	≥60 mm
Container Wall Thickness	Non-metallic Containers	Maximum wall thickness of plastic/glass/ceramic/paper: ≥5.0 mm
	Metal Container	Maximum wall thickness of iron and aluminum: ≥0.3 mm
Detection Performance	False Negative Rate	≤5%
	False Positive Rate	≤5%
Analysis Time	Non-metallic Containers	≤1 s
	Metal Container	≤5 s
Inspection Method		Non-contact inspection
Human-computer Interaction	Screen	10.1 inches, 1024 x 600
	Control	Support touch control
Network	Wired	10/100 M
	Wireless	Wi-Fi
Environmental Requirements	Operating Voltage	220 V AC
	Working Power Consumption	≤50 W
	Waterproof and Dustproof	IP50
	Operating Temperature	-10-55°C
Smart Analysis	Operating Humidity	≤97% (without condensation)
	Storage Environment	-25-70°C
	Altitude Requirements	<5000 m
Weight		<5 kg

Model		NP-SH100
Image		
Operating Temperatures		-5 to 55°C
Operating Humidity		95% humidity, no condensation
Dimensions		410 x 45 x 85 mm (W x H x D)
Weight		400 g (with battery)
Protection Level		IP31
Power Supply		9 V battery or rechargeable battery
Consumption		270 mW
Frequency		About 25 kHz
Operating Frequency		22 kHz
Current		<50 mA

Model		FBG-2-320-SP00
Image		
Ball Inner Diameter		750 mm
Tank Mouth Diameter		320 mm
Explosion-proof Capability		2 kg TNT Equivalent Weight
Cover Open Time		≤30 s
Total Weight		680 kg
Dimension		1100 x 920 x 950 mm (D x W x H)
Dust-proof Cover		Included
Holding Net		Included